

ALEXANDRIA PARK COMMUNITY SCHOOL

Park Road Alexandria 2015
phone +61 2 9698 1967
email alexparkcs-c.school@det.nsw.edu.au
web www.alexparkcs-c.schools.nsw.edu.au



Dear Parents, Carers and Students of Year 5 Opportunity Class for 2021,

Congratulations on achieving a place in the opportunity class at Alexandria Park Community School. We are very excited to be able to welcome you to our school community.

Information session for parents and students

We are holding an information session for parents and students from 9.30am-11.30am on Friday 22nd January. We ask that one parent/carer ONLY per student to attend this session.

Parent/carer and students will have the opportunity to meet Principal, Diane Fetherston, Assistant Principal, David Olsen and Class Teacher, Sarah Oluk. This is also a valuable opportunity for parents and students to make connections with others.

Please bring with you your letter of offer. You will be required to complete a COVID check in form.

Please enter from the Bunin gate on the corner of Power Ave and Park Rd

Students return to school dates for 2021

The Year 5 opportunity class will start school on Friday 29th January 2021.

	Wednesday 27/1/21	Thursday 28/1/21	Friday 29/1/21	Monday 1/2/21	Tuesday 2/2/21	Wednesday 3//2/21
Kindergarten 2021	Staff Development Day 1	Staff Development Day 2	Best Start Assessment	Best Start Assessment	Best Start Assessment	First Day of School Year 9.30am
Years 1-6 2021	Staff Only No students attend school on this day	Staff Only No students attend school on this day	First Day of School Years 1-6 Including 5OC	Second Day of School Years 1-6	Third Day of School Years 1-6	Fourth Day of School Years 1-6

Before school procedures on your child's first day in the Year 5 opportunity class for 2021

- Year 5 OC students will enter the school from the main gate (Bunin gate – see diagram of gate locations) on the corner of Power Ave and Park Rd. Please arrive no earlier than 8.40am.
- Parents and carers are not to enter the school site due to COVID19-safe practices
- When students arrive to school, they will be greeted by Year 6 students who will direct them to the Yarramundi to meet with the rest of the class
- In 2021, the K-6 school day commences at 9am and finishes at 2.45pm for years K-2 and 3pm for years 3-6. Primary school students should arrive to school between 8:40am and 9:00am. No primary students should be on the school site and unsupervised before 8:40am. A teacher will be on duty from 8:40am. Any students arriving to school prior to 8:40am must attend Camp Australia.

- Students attending before school care should arrive with a parent/carer after 7am and proceed directly to Camp Australia.
- On arrival to school, students are reminded that prior to 9am is a time for passive play on the Burra gorang only. This includes sitting and talking to friends and passive, quiet games. No balls should be kicked, passed or thrown and no running games are to be played. This ensures the safety of all community members in our playground before school. High school students have different break times to primary school students.

After school procedures

- Stage Three (Years 5 & 6) students exit the school from the Belmont St Gate at 3.00pm. Students who are walking home independently should leave straight after school from this gate.
- Kiss and Go students and students catching the school buses will use the bus bay gate at 3pm with a teacher supervising at the gate. Parents must notify teachers if their child is being picked up by car or travelling by school bus.
- If parents are collecting siblings, the procedure is to collect them from the gate designated to the eldest sibling. Eg. A girl in year one with an older sibling in Year Five would be collected from the Belmont St Gate at 3pm.
- Camp Australia will meet their students at the Camp Australia door at the back of the Burra gorang
- Chess and Yoga teachers will meet their students on the Burra gorang

School administration office - holiday opening hours

The Bunin (school administration office), will be open from 9.30am – 2pm on **Thursday 21st and Friday 22nd January 2021**. Office staff will be able to answer any administrative questions you have during this time. Our office staff will also be able to assist you with the purchase of uniforms and the payment of contributions and fees.

Gate Locations

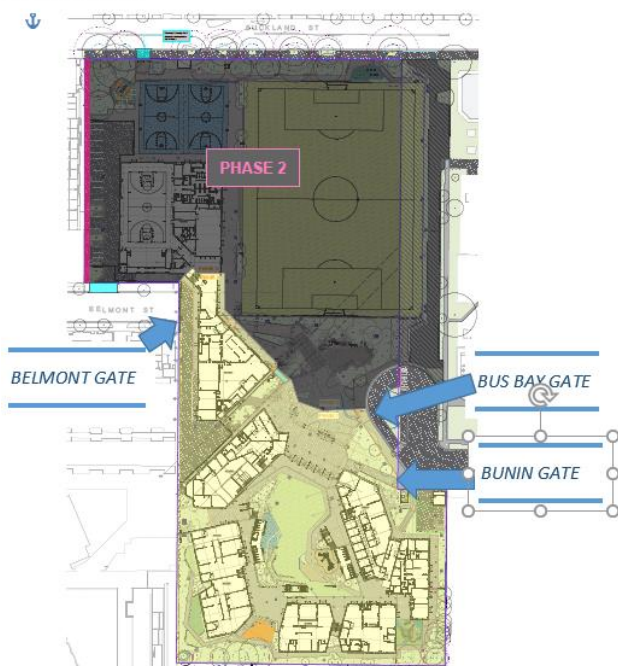

Ground floor plan

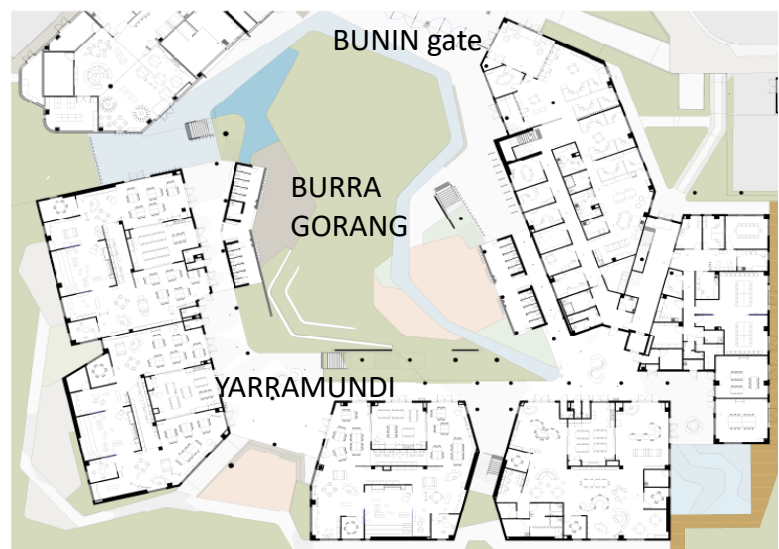

Bicycles and Scooters at school

It is great to see many students (and parents) who walk or ride their bikes or scooters to and from school. In this way physical activity is seamlessly integrated into the school day. Riders who bring their bicycles and scooters and skateboards onto school grounds are responsible for safe riding behaviours.

- Students are to always correctly wear an Australian Standards approved helmet when riding.
- Students must always ride in a safe manner following these guidelines and the NSW road rules relating to bicycles.
- Bicycles and scooters are not to be ridden in school grounds during or after school hours. All riders, students and adults are to dismount before entering the school grounds and walk their bikes or scooters with them whilst on the school grounds.
- Storing their bike or scooter in the correct manner in the appropriate storage area.

Parents and carers are responsible for:

- ensuring their child is wearing adequate protective gear, including a helmet, knee pads, wrist guards, elbow guards as required and that the bike or scooter is in good working order
- reinforcing the rules and safety advice for riding scooters and bikes to and from school

BIKES AND SCOOTERS ARE NOT TO BE RIDDEN INSIDE THE SCHOOL BY TEACHERS, PARENTS, STUDENTS OR VISITORS.

Before and after school care, run by Camp Australia

Before and after school care is located on the ground floor at the back of the Burra gorang. If you would like information about after school care please visit the Camp Australia website www.campaustralia.com.au

Primary school uniform for Kindergarten to Year 6 students

Students of Alexandria Park Community School are expected to wear full school uniform. The Parents and Citizens Association support this policy. It is an important part of our school's "**Code of Behaviour**", which was introduced after extensive consultation with students, parents, teachers and community groups.





The wearing of a school uniform:

- ✓ Advances strong community pride
- ✓ Promotes a positive school spirit
- ✓ Develops teamwork
- ✓ Is fair for all students
- ✓ Supports a safe and happy school
- ✓ Helps our community to recognise our students

All students are to wear full school uniform every school day. This presents a positive school image outside of the school and contributes to a shared school identity within.

The Uniform Shop

Please go the school office (Bunin) to purchase uniforms. It will be open on Thursday 21st and Friday 22nd of January 2021 from 9.30am-2.00pm. It is also open school days from 8.30 – 10.30am.

 <p>APCS Primary School Uniform Kindy to Year 6</p>				
	<p>School Shirt</p>	<p>School Jumper</p>	<p>School Jacket</p>	<p>Navy Shorts</p>
				
<p>Navy pants</p>	<p>Navy skirt/skort</p>	<p>Navy socks</p>	<p>Black shoes</p>	<p>School hat</p>

School uniform description

- APCS Red with blue sleeve polo shirt
- Navy shorts or navy pants or navy skirt or navy skort – shorts and skirts are to be worn to a modest and reasonable length for school attire.
- Black school shoes
- Navy socks or stockings
- Navy blue Jumper or jacket with school logo

These items are NOT school uniform

- Coloured or non-school hats and caps
- Hoodies
- Non APCS Jumpers, cardigans and pullovers
- Tights
- Jeans
- Non-navy pants or shorts
- Tops or pants with random logos

Sun Safety

All students should wear an Alexandria Park Community School hat at all times when in the school playground or on excursions. Hats can be purchased from the school uniform shop. K-6 students are required to follow the rule of 'No Hat, No Play'. All students should apply sunscreen each morning before school.

Student equipment lists for 2021

Please find the student equipment list for your child included with this note. It would be greatly appreciated if all students could have the relevant equipment organised and ready to bring to school for the first day in Week 2 (Monday 8th February 2021).

School contributions and fees

Please pay your school contributions for 2021 at the beginning of the school year. Payments for school contributions and fees go directly back into purchasing resources for students to use in their classes such as textbooks, sports equipment, art supplies, technology etc. Please help to support our school and student learning by paying your school fees and contributions.

2021 yearly contributions and fees:

- Kindergarten to Year 6.....\$50
- Technology Levy.....\$50
- P&C donation.....\$100

You can pay in person or online:

- In person at the administration office using: Cash, Cheque, Eftpos or Credit Card. Cheques are to be made payable to “*Alexandria Park Community School*”.
- To make online payments to the school via a secure payment page hosted by Westpac please follow these directions. Payments can be made using either a Visa or MasterCard credit or debit card. The payment page is accessed from the front page of the school’s website, <http://www.alexparkcs-c.schools.nsw.edu.au/> by selecting \$ **Make a payment**

Financial assistance

If you are experiencing any financial difficulties please contact the Principal, Ms Fetherston to arrange for a confidential discussion.

Food breaks & healthy eating

At Alexandria Park Community School there are two breaks for K-6 students.

Lunch 11.00am – 11.50am (this includes supervised eating time inside classrooms from 11:00am – 11:10am)

Afternoon Tea 1.50pm – 2.15pm (this includes supervised eating time inside classrooms from 1:50pm – 1:55pm)

All students are encouraged to eat a healthy and nutritious lunch and afternoon tea snack. This includes plenty of fruit and vegetables. Students should bring a refillable drink bottle with them to school every day, which can be refilled at one of the many bubblers or drinking fountains in the playground. Please minimise packaged food, which contributes to waste problems and can be difficult for younger students to open.

To find out more information on nutritious food choices for children at school, visit the following website: <https://www.healthykids.nsw.gov.au/teachers-childcare/nutrition-high-school/high-school-nutrition-guidelines.aspx>

Playground Spaces

During lunch and afternoon tea breaks, students will be able to make use of the following playground spaces at various times:

- Burra Gorang (including the play equipment)
- Milperra (COLA)
- Yarramundi (area designated for quiet play)
- Oraywa (roof top playground)

School canteen

The school canteen operates 5 days per week. The canteen operates under the guidelines of the NSW Department of Education *Nutrition in Schools* policy which can be found by visiting the following link: <https://education.nsw.gov.au/policy-library/policies/nutrition-in-schools-policy>

Students can order in person at the canteen before school, or online by registering with Flexischools - <https://flexischools.com.au/>

PBL (Positive Behaviour for Learning) at Alexandria Park Community School

Positive Behaviour for Learning, known as PBL is an evidence-based whole school systems approach that:

- Addresses the diverse academic and social needs of every student to support them to be successful
- Supports students in early childhood settings through to senior years of schooling
- Enables schools to establish a continuum of supports that are intensified to meet the needs of every student
- Is team driven, using a problem solving approach (data, systems and practices) that engages students, parents and all school staff
- Establishes positive social expectations for all in the school community
- Provides a framework for the school and its community to collectively support the wellbeing of every student.

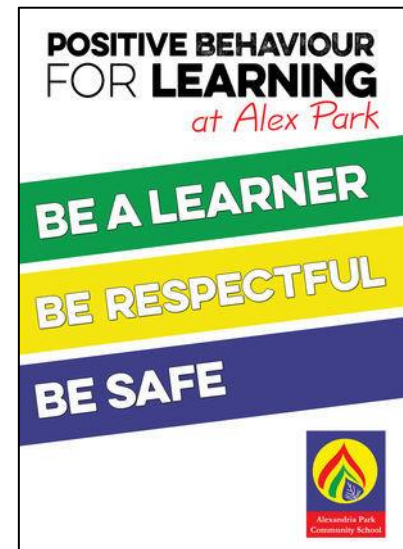

At Alex Park:

- Students respond positively as they have been taught what is expected of them
- Staff deliver consistent responses to student learning and behaviour
- Students feel safe and cared for at school. Their parents, family and community are more involved in their school
- Unproductive and challenging behaviour can be significantly reduced for most students.

Reward Systems:

- At Alex Park, we use a reward system where students are given 'Deadlies' for showing the PBL values of 'be a learner, be respectful and be safe'
- Deadlies are accumulated by individual students and students are able to participate in the annual PBL carnival
- Students may be given verbal praise, positive acknowledgement, merit awards or a PBL sticker to reinforce the PBL values



BEHAVIOUR CODE FOR STUDENTS

NSW public schools are committed to providing safe, supportive and responsive learning environments for everyone. We teach and model the behaviours we value in our students.

In NSW public schools students are expected to:

- Respect other students, their teachers and school staff and community members
- Follow school and class rules and follow the directions of their teachers
- Strive for the highest standards in learning
- Respect all members of the school community and show courtesy to all students, teachers and community members
- Resolve conflict respectfully, calmly and fairly
- Comply with the school's uniform policy or dress code
- Attend school every day (unless legally excused)
- Respect all property
- Not be violent or bring weapons, illegal drugs, alcohol or tobacco into our schools
- Not bully, harass, intimidate or discriminate against anyone in our schools

Schools take strong action in response to behaviour that is detrimental to self or others or to the achievement of high quality teaching and learning